

SBS Installation

GMN Installation Plan

Jessie Butler

Wednesday, February 17, 2021

Jefferson Lab



Objectives

- Where we started
 - I. End PREX/CREX run period
 - II. RHRS decommissioning planning
 - III. SBS prep work
 - IV. FML work planning
- Where we are
 - I. PREX/CREX equipment removal
 - II. RHRS decommissioning complete
 - III. Current status of SBS equipment/installation
 - IV. Current status of FML work list
- Where we are headed
 - I. SBS installation
- How we will get there
 - I. Details about the schedule/plan
- Summary

Objectives

- Where we started
 - I. End PREX/CREX run period
 - II. RHRS decommissioning planning
 - III. SBS prep work
 - IV. FML work planning
- Where we are
 - I. PREX/CREX equipment removal
 - II. RHRS decommissioning complete
 - III. Current status of SBS equipment/installation
 - IV. Current status of FML work list
- Where we are headed
 - I. SBS installation
- How we will get there
 - I. Details about the schedule/plan
- Summary

Where We Started

Bird's Eye View of Hall A



Where We Started

PREX/CREX (pivot) Equipment – Beam Left



PREX/CREX (pivot) Equipment – Beam Right



Where We Started

Decommissioning RHRS – Above Pivot



Decommissioning RHRS – Final Location



Where We Started

List of Other Scheduled Major Activities.

1. LCW Upgrade
2. Warmup the cryogenic system
3. 2MVA Power Upgrade
4. Compton Area Ground Water Leak Repair
5. Replace the Hall's Main AHU
6. Counting House Renovation
7. Various Power Outages
8. (Unplanned) Major Crane Repair



Where We Started

Proposed Location for LCW & 2MVA Power Upgrade



Where We Started



Compton Area Ground Water Leak



Objectives

- Where we started
 - I. End PREX/CREX run period
 - II. RHRS decommissioning planning
 - III. SBS prep work
 - IV. FML work planning
- Where we are
 - I. PREX/CREX equipment removal
 - II. RHRS decommissioning complete
 - III. Current status of SBS equipment/installation
 - IV. Current status of FML work list
- Where we are headed
 - I. SBS installation
- How we will get there
 - I. Details about the schedule/plan
- Summary

Where We Are

- PREX/CREX equipment has been removed
- RHRS is 90% decommissioned
- LCW upgrade is complete and awaiting pressure test
- Started building upstream shielded bunker
- Moved both spectrometers out to large angles
- Removed section of exit beamline
- Cryogenic system is warm
- Started laying out floor plates and tower base
- Crane repair is done
- Ground Water leak repair is 50% done
- 2MVA power upgrade is 50% done
- Counting House renovation has begun

Where We Are

LCW Manifold & 2MVA Switchgear: In-Progress



Upstream Shielded Bunker Construction: In-Progress



Where Are We

Pivot Area From Beam Right Looking Downstream



Pivot Area From Beam Left Looking Upstream



Where We Are



Ground Water Leak: In-Progress

Crane Repair: Completed

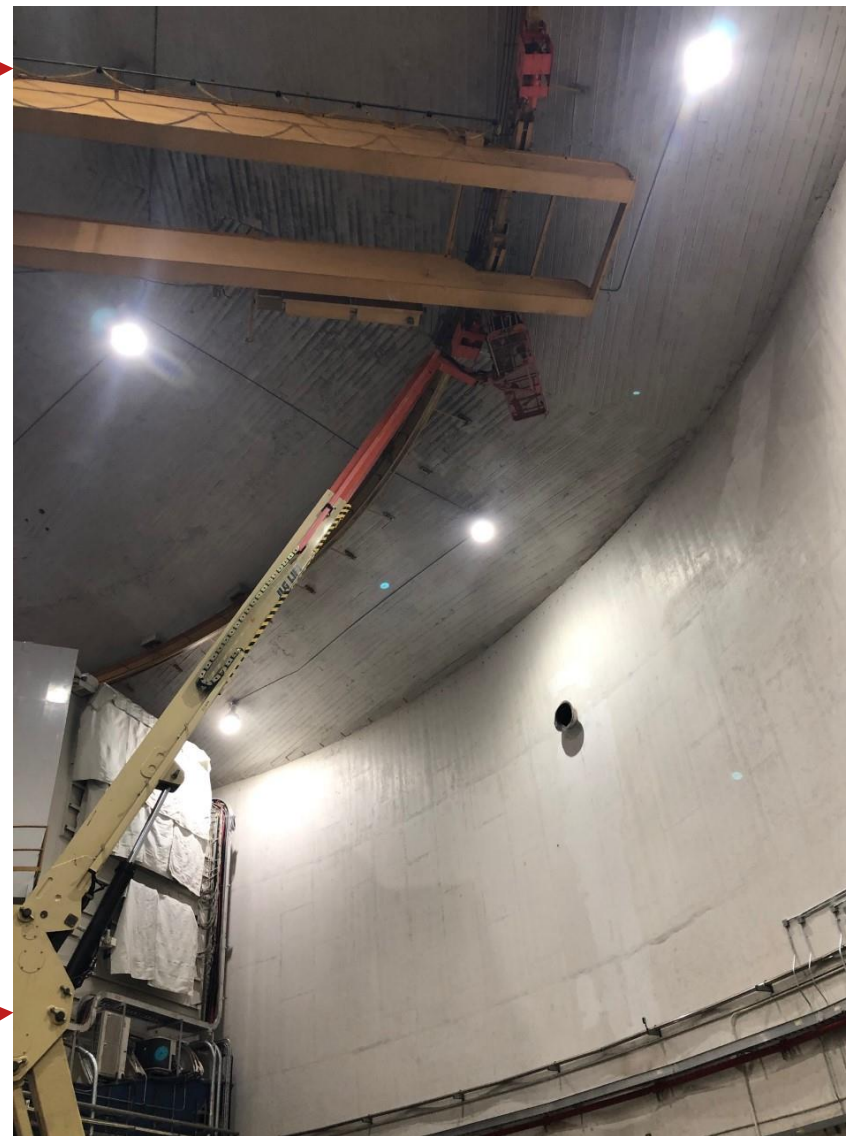

Objectives

- Where we started
 - I. End PREX/CREX run period
 - II. RHRS decommissioning planning
 - III. SBS prep work
 - IV. FML work planning
- Where we are
 - I. PREX/CREX equipment removal
 - II. RHRS decommissioning complete
 - III. Current status of SBS equipment/installation
 - IV. Current status of FML work list
- Where we are headed
 - I. SBS installation
- How we will get there
 - I. Details about the schedule/plan
- Summary

Where Are We Headed

GMN Experiment Setup

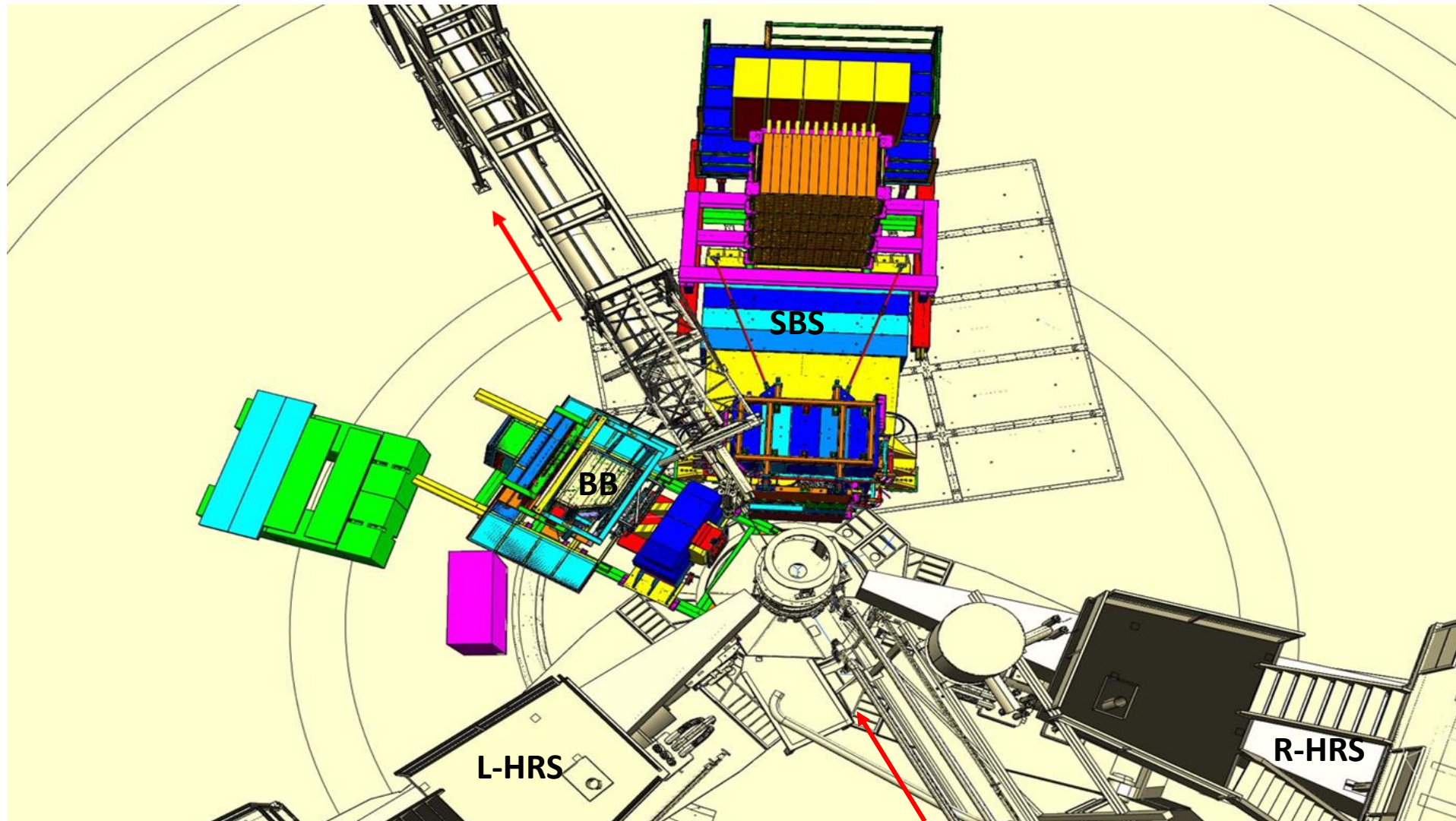

Objectives

- Where we started
 - I. End PREX/CREX run period
 - II. RHRS decommissioning planning
 - III. SBS prep work
 - IV. FML work planning
- Where we are
 - I. PREX/CREX equipment removal
 - II. RHRS decommissioning complete
 - III. Current status of SBS equipment/installation
 - IV. Current status of FML work list
- Where we are headed
 - I. SBS installation
- How we will get there
 - I. Details about the schedule/plan
- Summary

How We Will Get There

- Focus on meeting goals of three phases of the installation:
 - Phase One: Equipment removal & decommissioning
 - Phase Two: SBS equipment installation
 - Phase Three: Equipment startup & commissioning
- Phase 1 started at the beginning of the installation and goes through ~Feb. 28th.
- Phase 2 targeted start date is Mar. 1st and goes through ~ June 30th.
- Phase 3 targeted start date is July 1st and goes until the start of the run (~Sep 3rd).

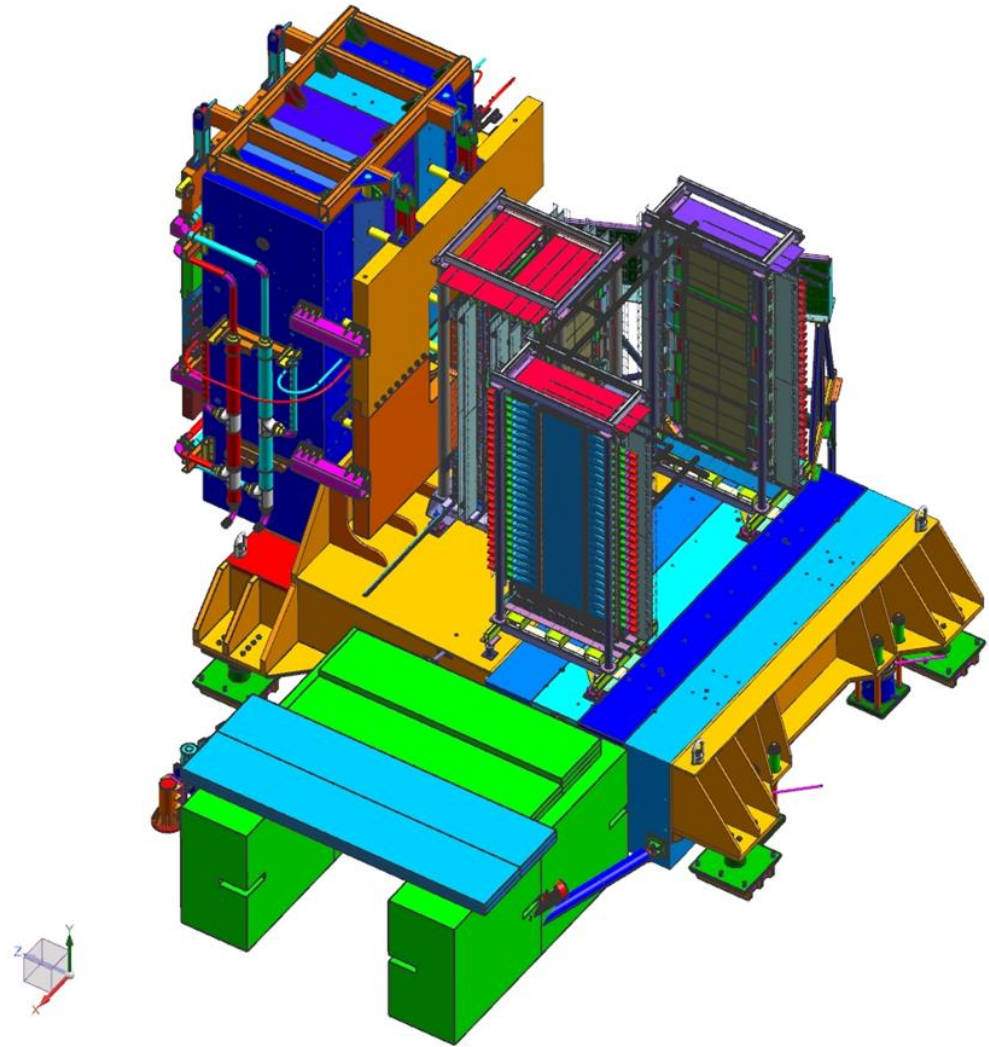

How We Will Get There

- Communicate and work with the collaboration:
 - Attend SBS weekly meetings
 - Provide feedback, answer questions, and discuss progress
 - Provide targeted dates as to when equipment will be transported to Hall A
 - Support activities that are happening outside of the hall (e.g., equipment assembly, parts fabrications, etc.)
- Control what we can, monitor what we can't control, and have a backup plan:
 - JLAB'S COVID protocols
 - Work Safely
 - Accelerate activities when possible
 - Constantly update schedule
 - Track outside groups work progress in the hall
 - Work additional hours
 - Seek additional resources

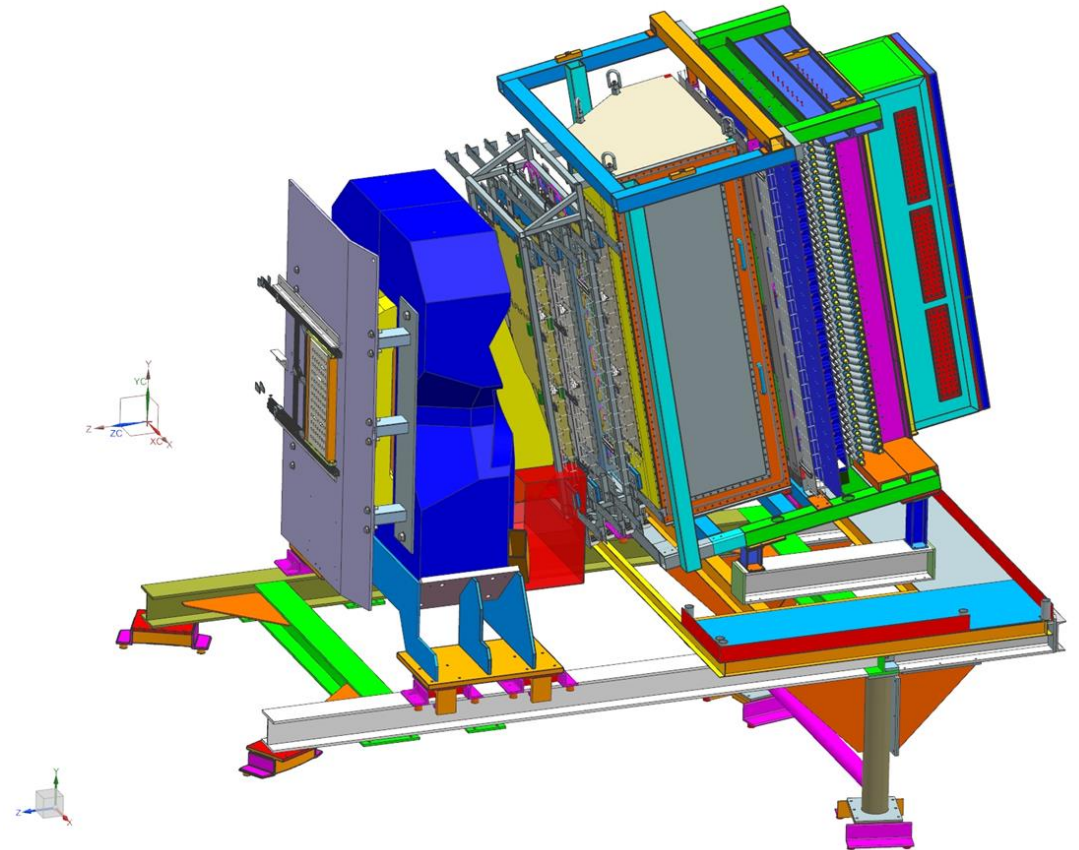

Objectives

- Where we started
 - I. End PREX/CREX run period
 - II. RHRS decommissioning planning
 - III. SBS prep work
 - IV. FML work planning
- Where we are
 - I. PREX/CREX equipment removal
 - II. RHRS decommissioning complete
 - III. Current status of SBS equipment/installation
 - IV. Current status of FML work list
- Where we are headed
 - I. SBS installation
- How we will get there
 - I. Details about the schedule/plan
- Summary

Summary

jbutler@jlab.org or x5544

- Where we started
- Where we are
- Where we are headed
- How we will get there
- Summary



Blank Slide

- Blank Slide

Backup Photos

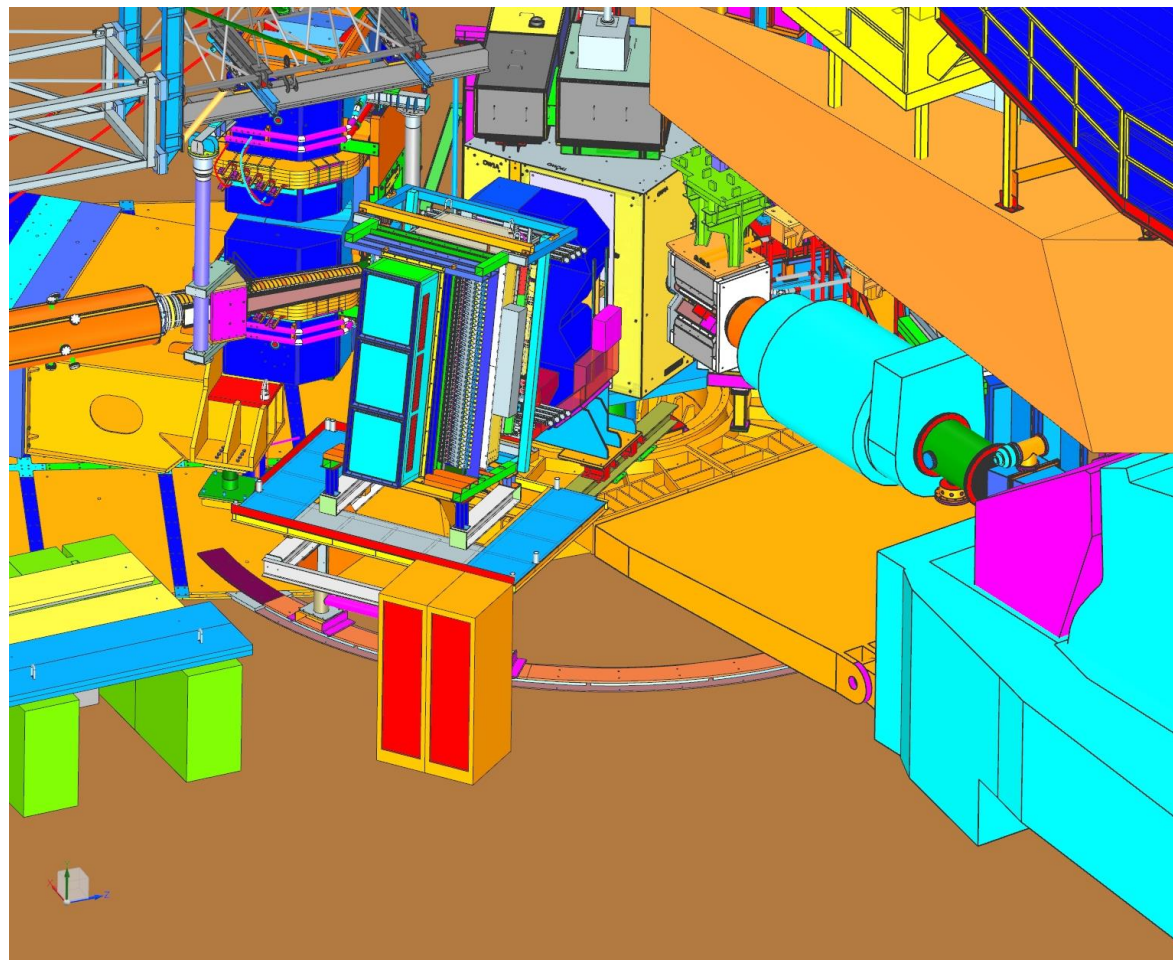

- 1: Hall A Tech Staff
- 2: Hall A Tech Staff
- 3: Spectrometer Support Group

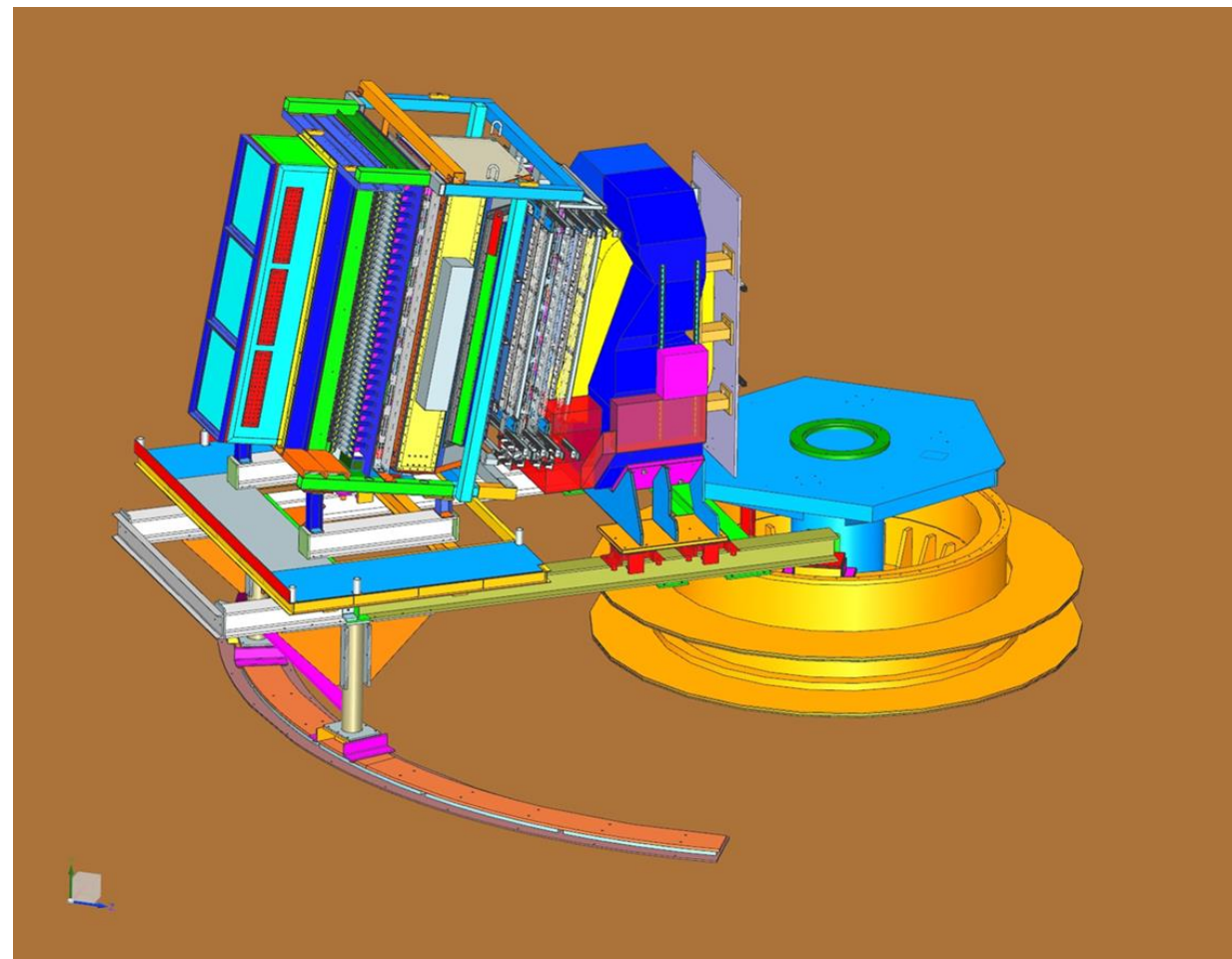

Backup Photos

Beamline Configurations

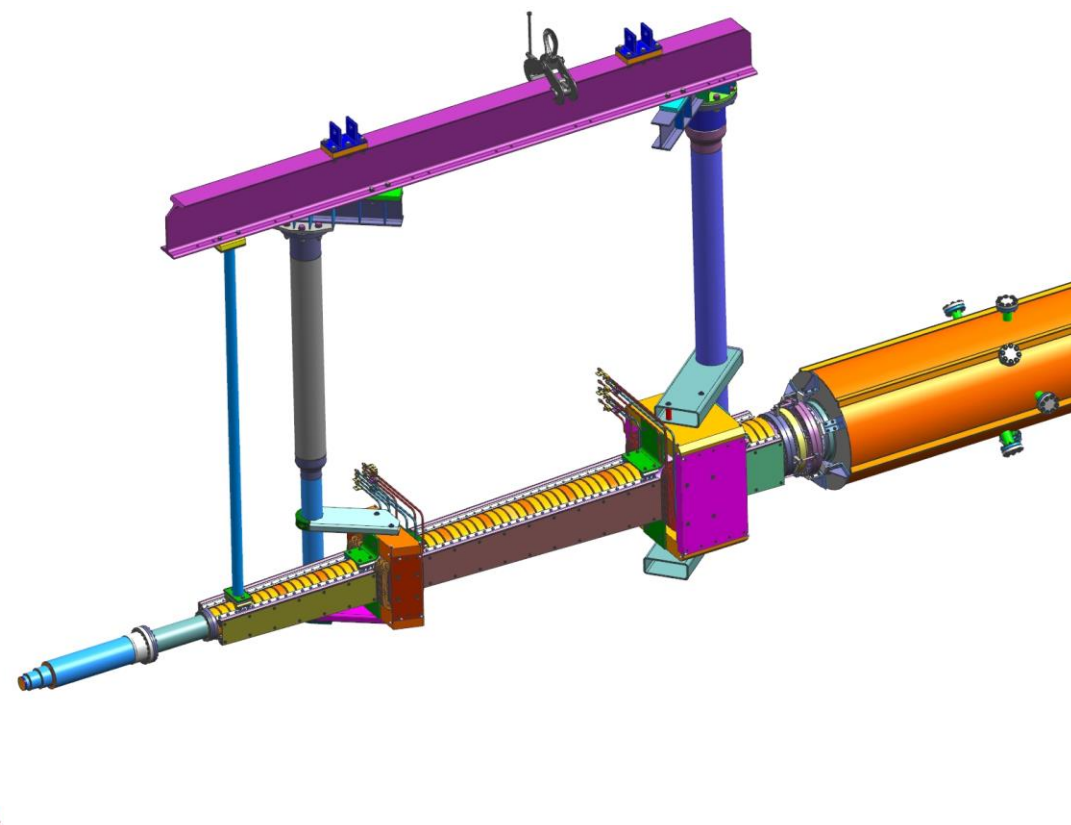
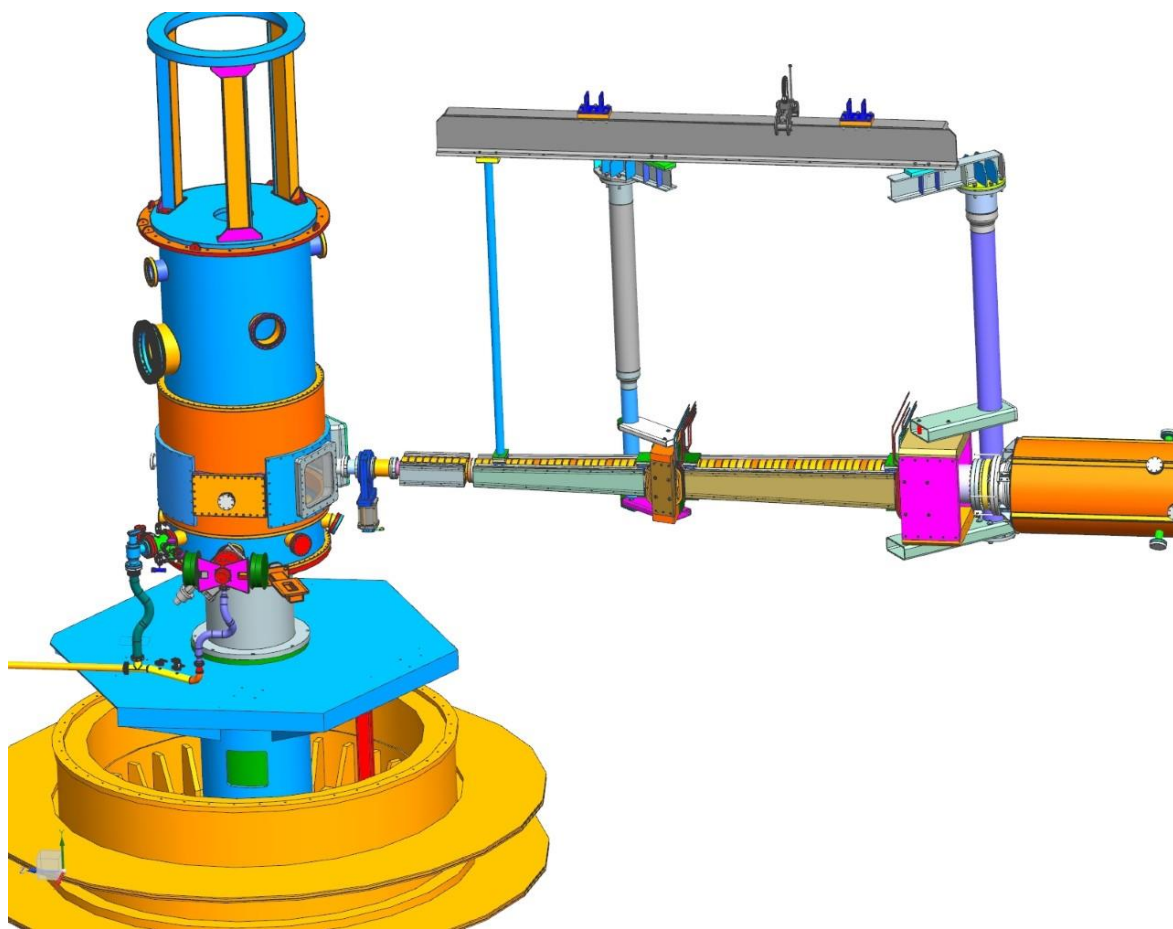

- 1: Hall A Tech Staff
- 2: Hall A Tech Staff
- 3: N/A

Backup Photos

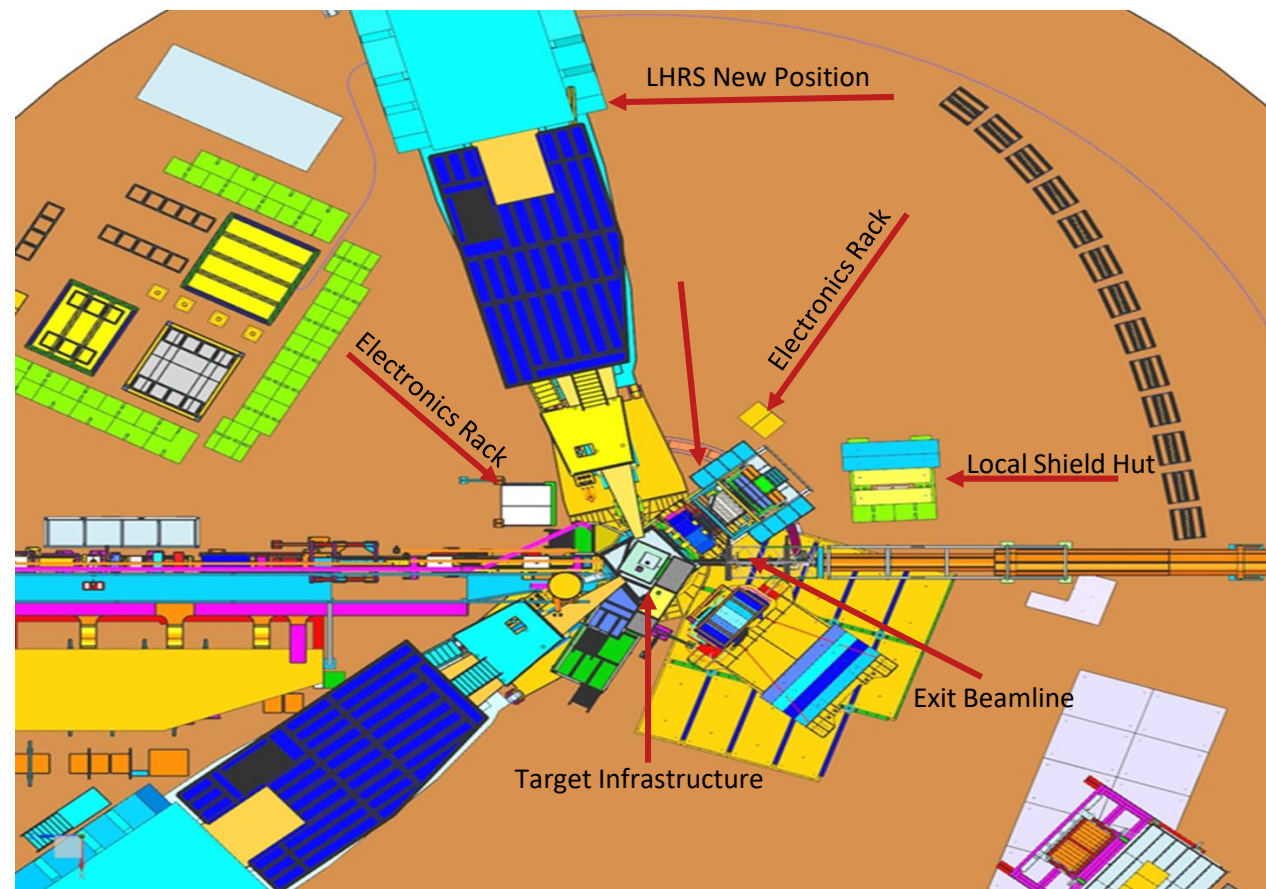
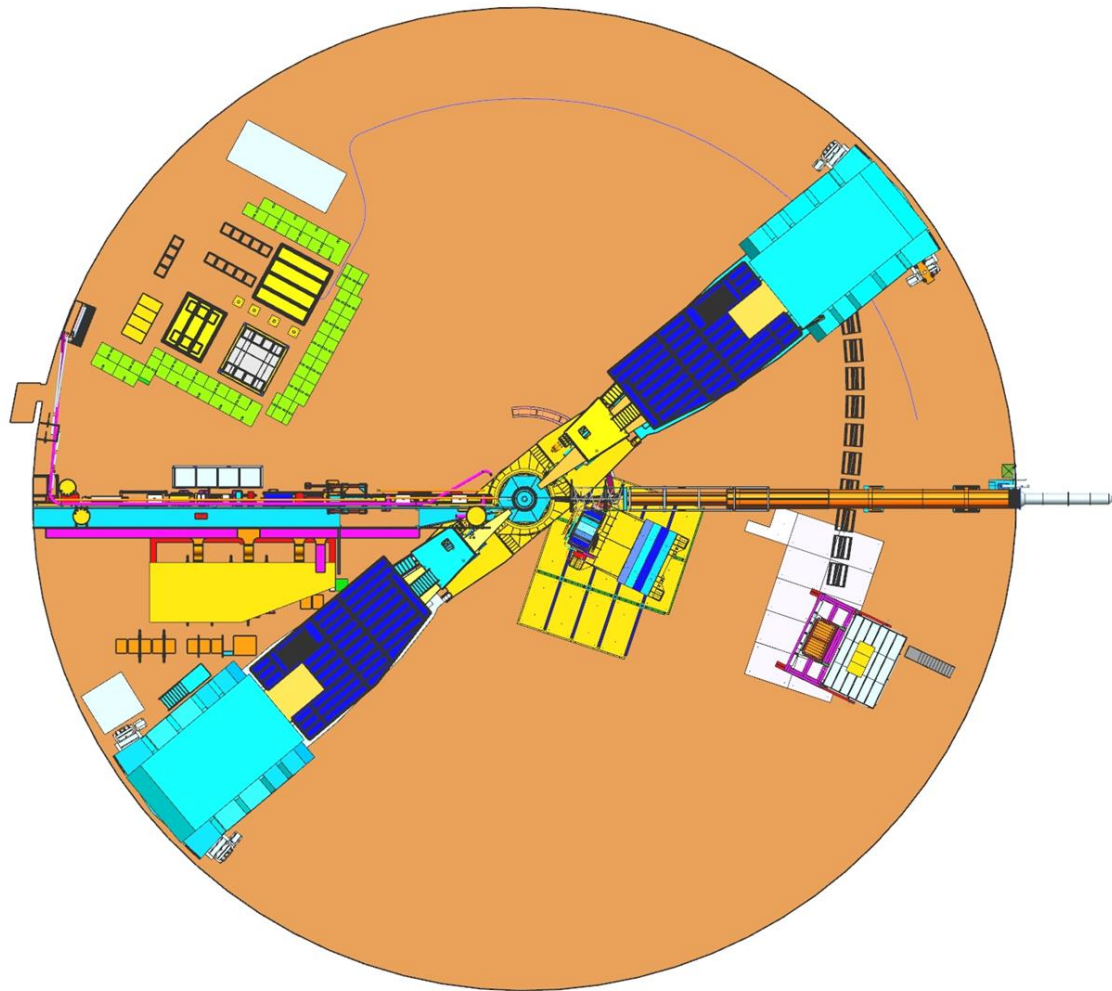

Backup Photos

Pivot Area Setup

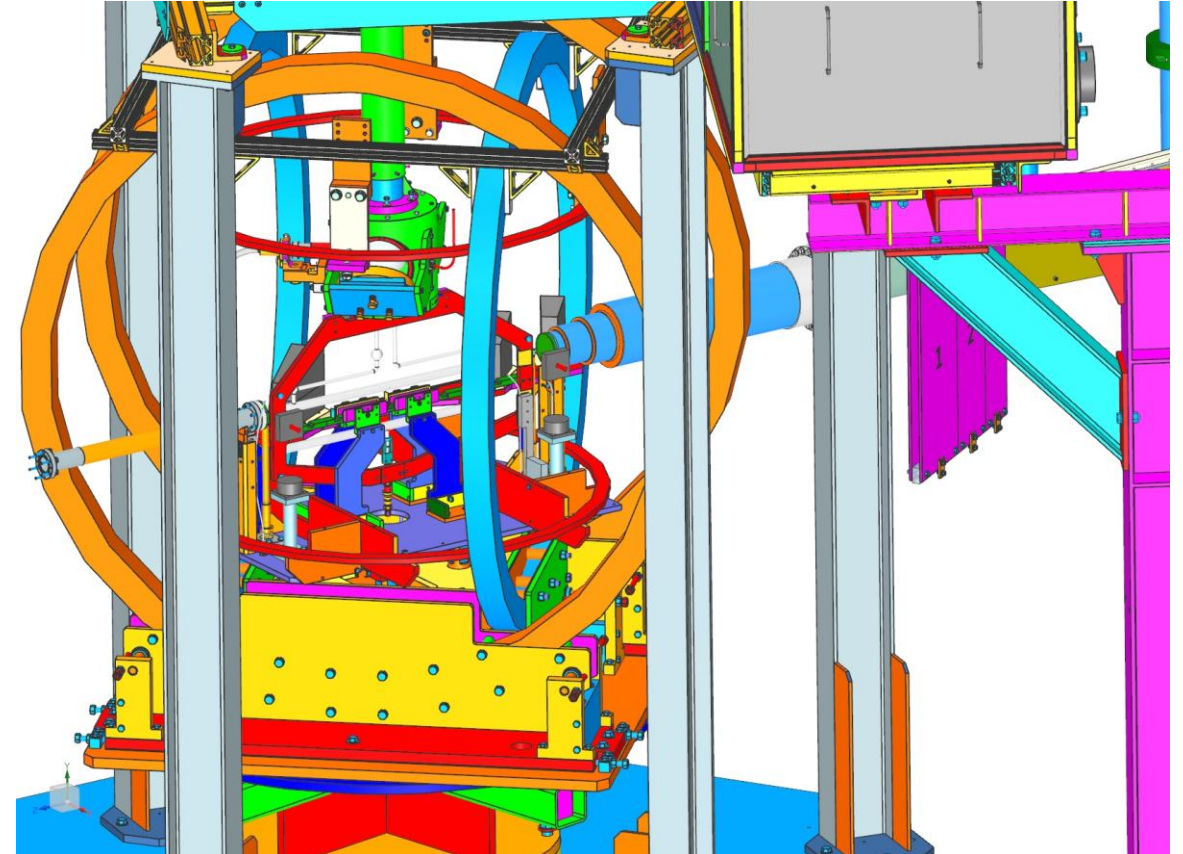
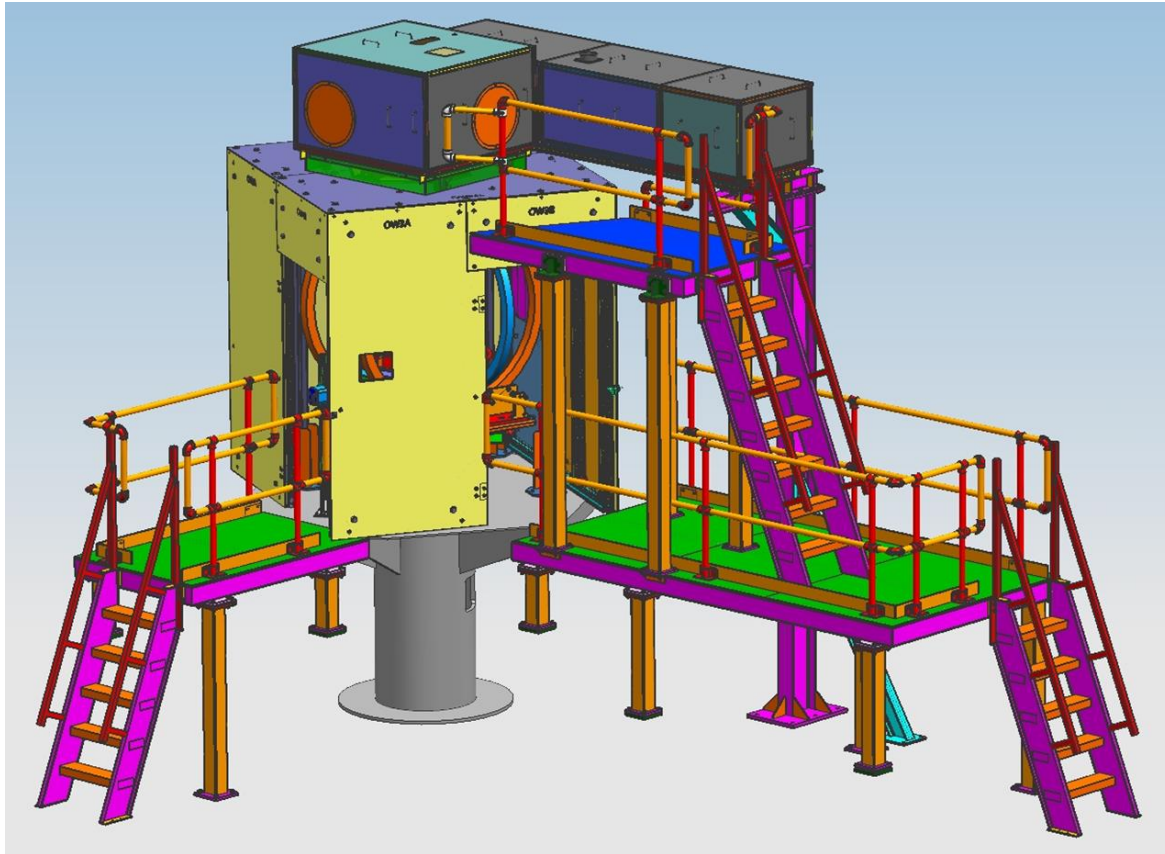

- 1: Hall A Tech Staff, Target Group, & Collaboration
- 2: Hall A Tech Staff, Target Group, & Collaboration
- 3: Target Group & Collaboration